

Bronze Swing Check Valve

Model: SD-GCV20/W

The SD-GCV20/W valve is manufactured in accordance with BS 5154 PN20 which can be used for heating, cooling, sanitary, pneumatic systems, waterworks, autoclaves, pumps. It is suitable for installation either in vertical or horizontal pipelines to allow unidirectional flow.



Product Specifications:

Working Pressure	PN20
Working Temperature	-10°C - 80°C
Thread	BS 21 (B.S.P.T.)
Approvals/Listings	WRAS <small>Water Regulations Advisory Scheme</small>

Bronze Swing Check Valve

Product Dimensions:

Bronze Swing Check Valve

DN	L	H	d
15	58	37	12.0
20	66	43	18.0
25	76	49	24.0
32	88	57.5	30.6
40	108	63	37.0
50	133.5	72	48.6

NOTE: Dimensions are in mm

Drawing Specification

No.	Part	Material
1	Drive Screw	Copper
2	Name Plate	Aluminium
3	Cap	Bronze
4	Packing	PTFE
5	Hinge Pin	Stainless Steel 304
6	Hinge	Bronze
7	Disc	NBR
8	Disc Holder	Bronze
9	Hinge Nut	Stainless Steel 304
10	Body	Bronze

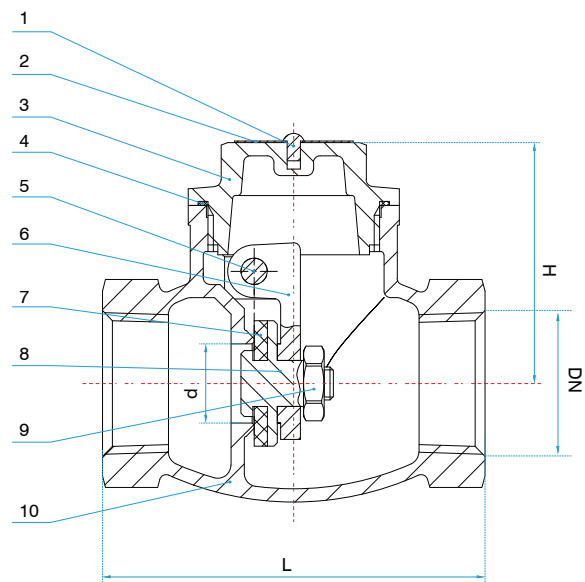

Bronze Swing Check Valve

Miscellaneous Data:

1. Ordering Information

Example: SD-GCV20/W-20

- SD-GCV20/W is the part number
- (20) Size

2. Contact Information

For further information on any aspect of the SHIELD Valves products please contact below:

MIDDLE EAST & AFRICA	UNITED KINGDOM
Jebel Ali Free Zone, Dubai, UAE P.O Box: 61199 Tel.: +971 4 881 2070 Fax: +971 4 881 2198 Email: shieldme@shielglobal.com	Unit 3, Endeavor Drive, Basildon-Essex, SS3 14WF Tel.: +44 1708 377731 Fax: +44 1708347637 Email: shielduk@shielglobal.com